

CERTIFIED LAND CORNER RECORDATION '89 FEB 17 AM 10 26

DESCRIPTION OF CORNER EVIDENCE FOUND, AND ORIGINAL RECORD (if known)  
 S.21 S.22 Found 2" iron pipe in East-West fence projecting 0.5' above ground,  
 S.28 S.27 accepted location.  
 T.13N., R.70W.  
 6th P.M.  
 G.L.O. Record: Granite boulder 20"x6"x6" set by J. Wesley Hammond, October 22, 1872.

DESCRIPTION OF MONUMENT AND ACCESSORIES ESTABLISHED TO PERPETUATE THE ORIGINAL LOCATION OF THIS CORNER:

At the corner: Not remonumented.

Accessories : See ties below.

SKETCH, WITH COURSE AND DISTANCE TO ADJACENT CORNER IF DETERMINED IN THIS SURVEY.  
 (May Sketch or Paste Reproduction on Reverse Side.)

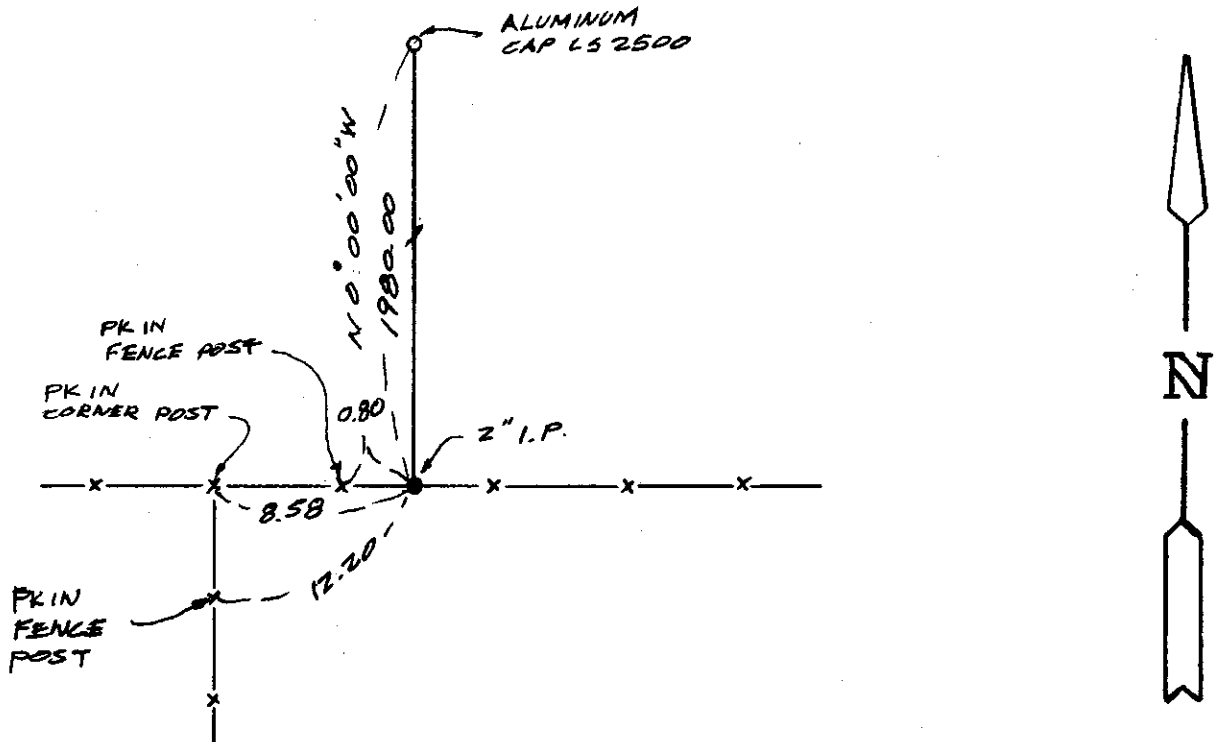

I, John A. Steil certify that I have carefully performed or reviewed the work done on the diagrammed corner as reported on this recordation form and approve the same.

Signature of Surveyor

L.S. 2500  
 Registration No.



STATE OF WYOMING,  
 Office of Clerk and Recorder,  
 County of \_\_\_\_\_

This "corner record" was filed for record on the \_\_\_\_\_ day of \_\_\_\_\_, 19\_\_\_\_, was noted on the cross-index plat and is assigned page No. \_\_\_\_\_, in book No. \_\_\_\_\_.

James C. Whitehead  
 County Official

Cross index No.	R-13	T. 13N	R. 70W	Mer. 6th
				Mer.
				Mer.
				Mer.
				Mer.
				Mer.
				Mer.